

How to connect my email account to Google Mail



- 有些公司不容许员工把公司邮件转发到私人邮箱，请先问清楚才做。
- Forwarding business emails to private mailboxes are not allowed in some business. Please make sure you are allowed first.

- Please do not forward emails to Gmail. They will block our server if everyone forwarded some junk mails to them.
- Please use the following method to let Gmail “pull” mails from our server, they will not block us this way.
- 请不要将邮件转发到Gmail。如果大家都转发了一些垃圾邮件，Gmail会封锁我们的服务器。
- 请使用以下方法让Gmail来收取邮件，这样 Gmail 就不会封锁我们了。

Login to Gmail

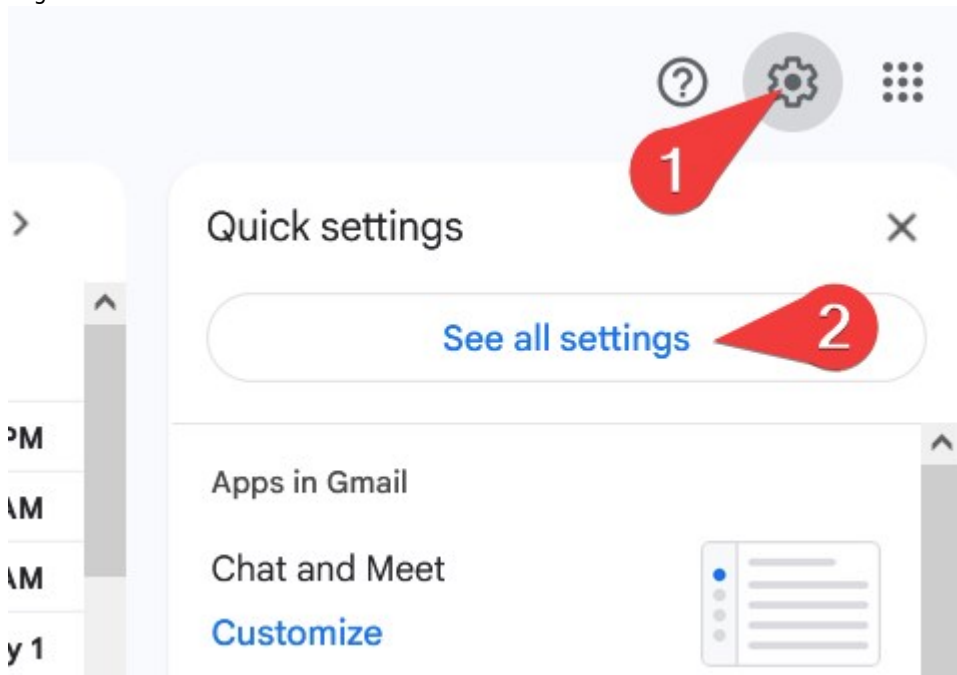

Open Accounts and Import
Click Add another email address

Settings

1

General Labels Inbox **Accounts and Import** Filters and Blocked Addresses Forwarding and POP/IMAP Add-ons (

Change account settings:

[Change password](#)
[Change password recovery options](#)
[Other Google Account settings](#)

Using Gmail for work?

Businesses get yourname@example.com email, more storage, and admin tools with Google Workspace.

Import mail and contacts:

[Learn more](#)

Import from Yahoo!, Hotmail, AOL, or other webmail or POP3 accounts.

[Import mail and contacts](#)

Send mail as:

(Use Gmail to send from your other email addresses)

[Learn more](#)

Derek Chan <sxlderek@gmail.com>

2

Add another email address

When replying to a message:

- ☒ Reply from the same address the message was sent to
☐ Always reply from default address (currently sxlderek@gmail.com)

(Note: You can change the address at the time of your reply. [Learn more](#))

Type your Name, email address and then Next Step

Add another email address you own

Enter information about your other email address.

(your name and email address will be shown on mail you send)

Name:

Email address:

☒ Treat as an alias. [Learn more](#)

[Specify a different "reply-to" address](#) (optional)

Type your SMTP Server (usually h12.hksx.com)

Type your email address and password

Port is 587 and use TLS for connection

Click Add Account

Add another email address you own

Send mail through your SMTP server

Configure your mail to be sent through sxl.net SMTP servers [Learn more](#)

SMTP Server: Port: 
Username:
Password:

- ☒ Secured connection using [TLS \(recommended\)](#)
☐ Secured connection using [SSL](#)

Google will send a confirmation link to your email address

Open your Outlook or Webmail to confirm it.

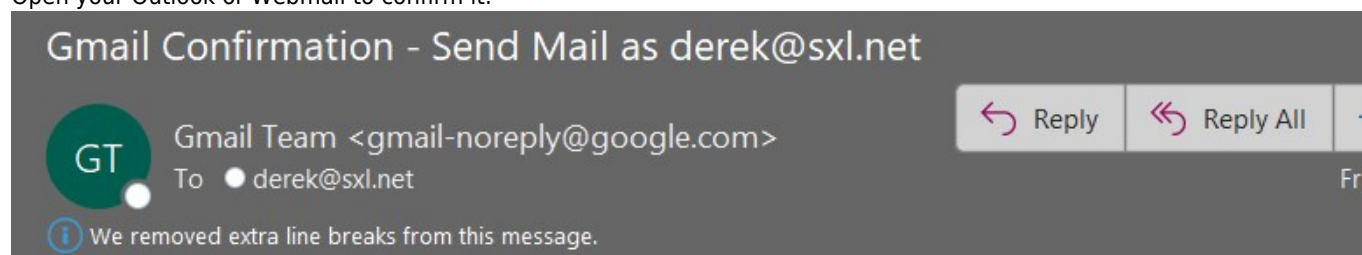

You have requested to add derek@sxl.net to your Gmail account.

Before you can send mail from derek@sxl.net using your Gmail account (sxlderek@gmail.com), please click the link below to confirm your request:

Click this link to confirm

https://mail.google.com/mail/u/0/ik5BANGjdJ_VBpXZX-ulEY0SaF87zdIPCGu77FMhM5iKWofE2TF0aJ9RIUUGmulz2OMwAa3UIC1XlQeHPHIL-fna%5D-Ol8rnU_Py_vF2r2UC9IXuYNFbxg

If you click the link and it appears to be broken, please copy and paste it into a new browser window.

Click Confirm again



Confirmation

Please confirm sending mail as **derek@sxl.net**.

Click here to return to your Gmail account: <https://mail.google.com>.

Confirm



From now on, you will receive your own email in Gmail

When you send message, you can choose the From address

New Message

From

Derek Chan <sxlderek@gmail.com>

To

Derek Chan <sxlderek@gmail.com>

Derek Chan <derek@sx1.net>

Cc Bcc

Subject

--

Derek Chan

↶ ↷

Sans Serif

↑↓

B

I

U

A

☰ ☷ ☹

☰ ☷ ☹

☰ ☷ ☹

☰ ☷ ☹

Send

A

📎

🔗

😊

📎

🖼️

🔒

✍️

⋮

🗑️

If you also use this Gmail account on your hand phone and tablet, you can easily access your emails everywhere.

From:
<https://wiki.sxl.net/> - wiki

Permanent link:
https://wiki.sxl.net/how_to_connect_my_email_account_to_google_mail?rev=1746615432

Last update: **2025/05/07 10:57**

